

51 Sq.ft. (gross)

78 Sq.ft. (gross)

總面積2,161平方呎

總面積2,078平方呎

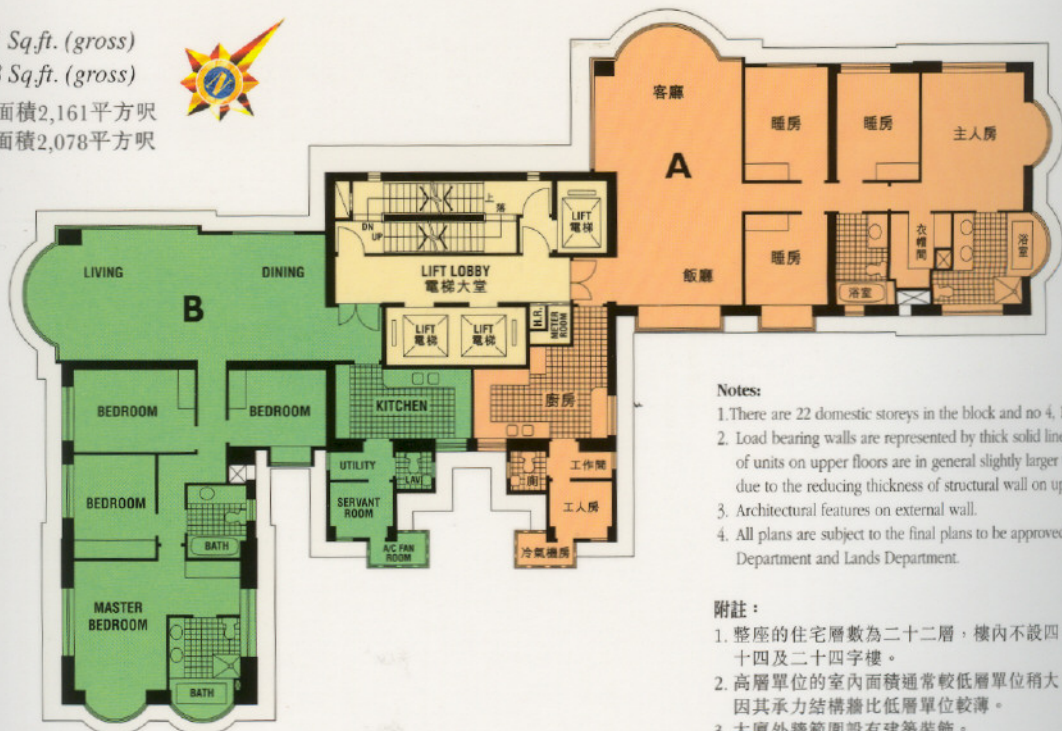

Notes:

1. There are 22 domestic storeys in the block and no 4, 14 and 24/F.
2. Load bearing walls are represented by thick solid lines. The internal areas of units on upper floors are in general slightly larger than lower floors due to the reducing thickness of structural wall on upper levels.
3. Architectural features on external wall.
4. All plans are subject to the final plans to be approved by the Buildings Department and Lands Department.

附註：

1. 整座的住宅層數為二十二層，樓內不設四、十四及二十四字樓。
2. 高層單位的室內面積通常較低層單位稍大，因其承力結構牆比低層單位較薄。
3. 大廈外牆範圍設有建築裝飾。

此圖經建築師及地政署最後批准之